



ATOM Repeater System QUICK INSTALLATION GUIDE



For your safety, please beware of power lines at all times during the installation. Please make sure to take appropriate safety measures for protection. Contact with high-voltage power lines can cause death and/or serious injury. Please handle the equipment with care. Mechanical shock due to dropping or mishandling can permanently damage sensitive RF components.

The Coiler Atom Repeater is designed to improve cell phone signal coverage and enhance reception in indoor areas where a mobile signal is limited or compromised due to construction structures or natural obstacles. The Atom has been optimized to provide mobile signal coverage and improve data transmission in homes, offices, conference rooms, shops and other small indoor areas.

A Donor Antenna (Outdoor)



A The donor antenna should be located in the strongest signal reception area (where the mobile phone shows the highest number of bars). This may be on the side of the building (on a wall), or inside the building close to the window. If the donor antenna is to be installed inside the building, please ensure the maximum distance possible between the donor antenna and the main repeater unit. Back-to-back positioning will guarantee the best performance.

B The main repeater unit will be located inside the building near to the weakest signal area, centrally to the area requiring coverage. For the best performance, the repeater should be installed on the wall at least 2 meters from the floor. Make sure that the distance between the repeater unit and the donor antenna is at least 8 meters. Remember that the length of the cable is 15 meters, so make sure you have reserved enough cable to connect the donor antenna and the repeater unit. Use the mounting kit to fasten the main unit bracket first. Place the main unit on the bracket.

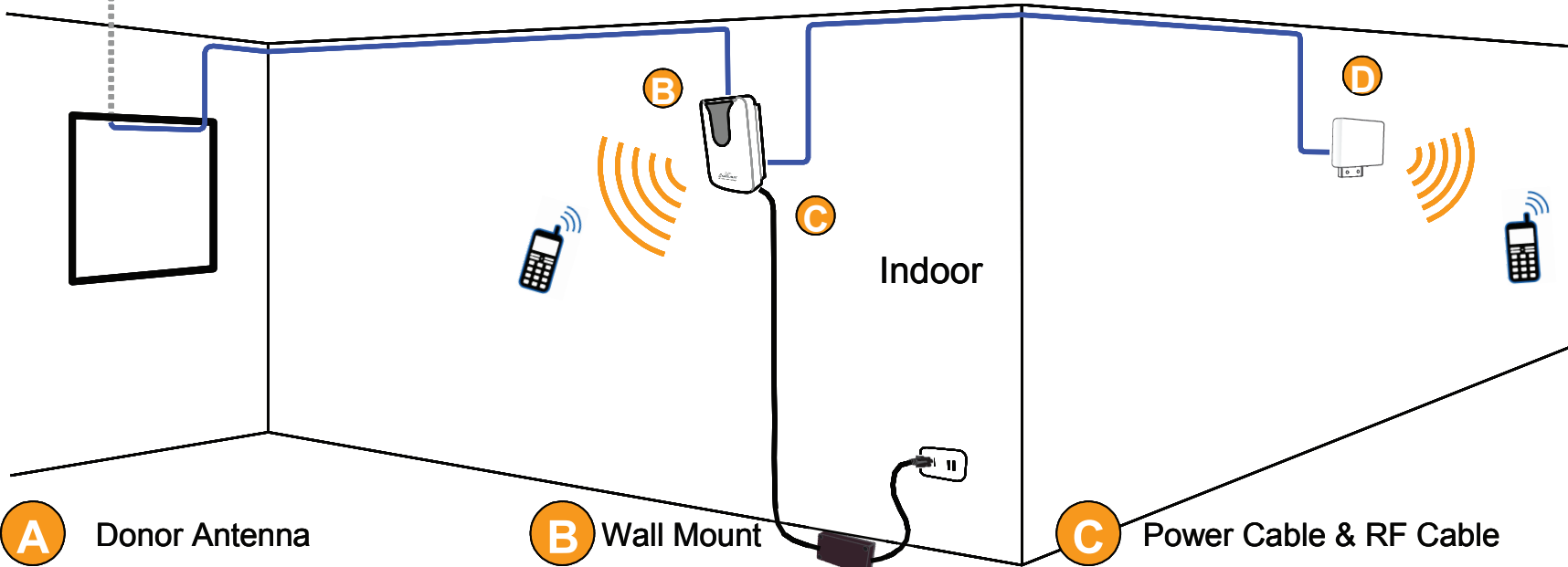

C Route the cable between the donor antenna and the repeater unit. Connect the cable to the connector marked BTS on the repeater. Connect the other end to the donor antenna. Make sure that all of the connections are tightly fastened. Connect the power cable of the adaptor to the main unit where indicated "DC6V", and plug the adaptor into the power plug. If the installation is correct, the DC Power LED and Performance LED should be GREEN and the displayed signal bars should NOT be changing radically (no more than 2 bars). If the performance LED turns into ORANGE, that means the donor signal is too low to obtain an acceptable coverage. Please search for another location to install the donor antenna. If the performance LED turns into RED, that means the donor antenna and repeater are too close to each other. Please increase the distance between the two. **The Atom Repeater is now ready to work!** For troubleshooting, please refer to the installation manual.



A Donor Antenna

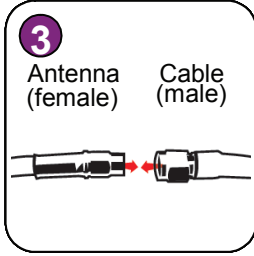
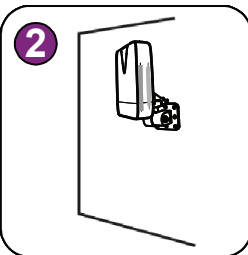

B Wall Mount

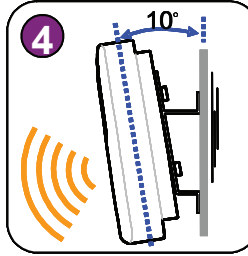
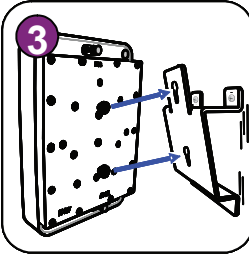
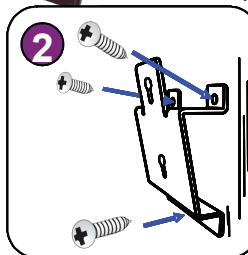
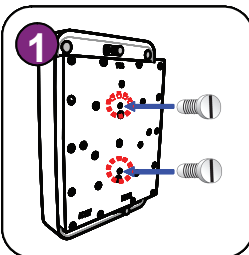

C Power Cable & RF Cable

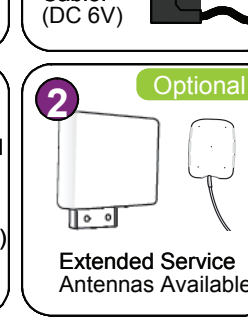
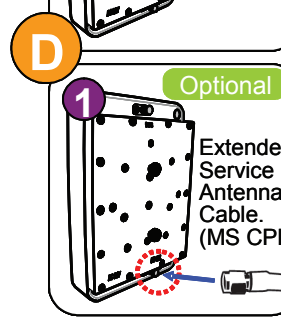
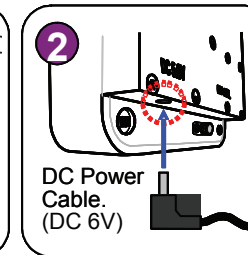
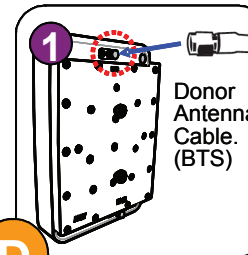

D You may connect additional indoor antenna in order to provide coverage in other room or floor. To do so, connect cable to the port marked as MS CPL. Make sure to unplug the power before making any connections. Also, make sure that the additional antenna is properly separated from the the donor antenna (at least 8m). If the extension port is not used, make sure that it remains terminated.